CONTRACTING WINTER SERVICES

EMMET COUNTY ROAD COMMISSION EXPERIENCE



LEROY P. SUMNER
LARRY WILLIAMS
FRANK ZULSKI, JR.
BRIAN A. GUTOWSKI, P.E.
ENGINEER – MGR.
JUDY FOUCH CLERK



2265 E. HATHAWAY ROAD
HARBOR SPRINGS,
MICHIGAN 49740
OFFICE: (231) 347 – 8142
FAX: (231) 347 – 5787
EMMETCRC@EMMETCRC.COM

Snow Plow Services Bid

The Emmet County Road Commission will receive sealed bids until 9:00 A.M., November 19, 2013, at which time they will be opened and read aloud for snowplowing services on roads in specified subdivisions in Emmet County for the 2013/2014 winter season and possible mainline plowing in the event of an emergency. Additional information may be obtained at the offices of the Emmet County Road Commission at 2265 E. Hathaway Road, Harbor Springs, MI 49740.

EMMET COUNTY ROAD COMMISSION
Frank Zulski, Jr. – Chairman
Leroy Sumner – Vice Chairman
Larry Williams – Member

Bid Price Structure

1. Bid to be based on the cost of plowing one complete time (cycle) including intersection clearing.
2. The contractor shall submit an invoice to the Road Commission in order to be paid. Invoices must show each cycle plowed, date of service, and unit cost.
3. The Road Commission approves bills every two weeks. It is the responsibility of the contractor to provide the invoice in a timely manner in order to be paid.
4. Each route will be awarded in the best interest of the Road Commission.
5. Prices to remain firm throughout contract period.

Areas to be Bid

The Emmet County Road Commission is bidding out the snowplowing services of 9 different routes in the county plus seeking a bid for possible mainline snowplowing services. The following names of the routes are to be used under this contract. Attached are the individual roads and accompanying maps for each bid area.

1. Pleasantview Route: Mileage – 6.64 miles
2. Harbor Route: Mileage – 2.31 miles
3. Bear Creek Route: Mileage – 3.26 miles
4. Bay View Route: Mileage – 1.79 miles
5. Resort South Route: Mileage – 3.26 miles
6. Resort North Route: Mileage – 3.29 miles
7. Oden Route: Mileage – 3.52 miles
8. Conway Route: Mileage – 3.84 miles
9. N. US 31 Route: Mileage – 1.41 miles
10. Mainline Paving: The road commission is seeking information and bids on the ability of the contractor to perform mainline snowplowing on roads including US 31, US 131, M-119, M-68, primary roads, and local roads. This information is being sought in case the need arises where the Road Commission is unable to perform the work in an emergency situation.

ROUTE #4

BAYVIEW ROUTE

Road	Length (mi.)	Township
Division Street	0.25	Bear Creek
Hampton	0.29	Bear Creek
Kent	0.12	Bear Creek
Newberry	0.14	Bear Creek
Old Tannery Creek Road	0.34	Bear Creek
Rice Street	0.14	Bear Creek
Shire	0.32	Bear Creek
Turbush	0.13	Bear Creek
Vinton	0.06	Bear Creek

BAY

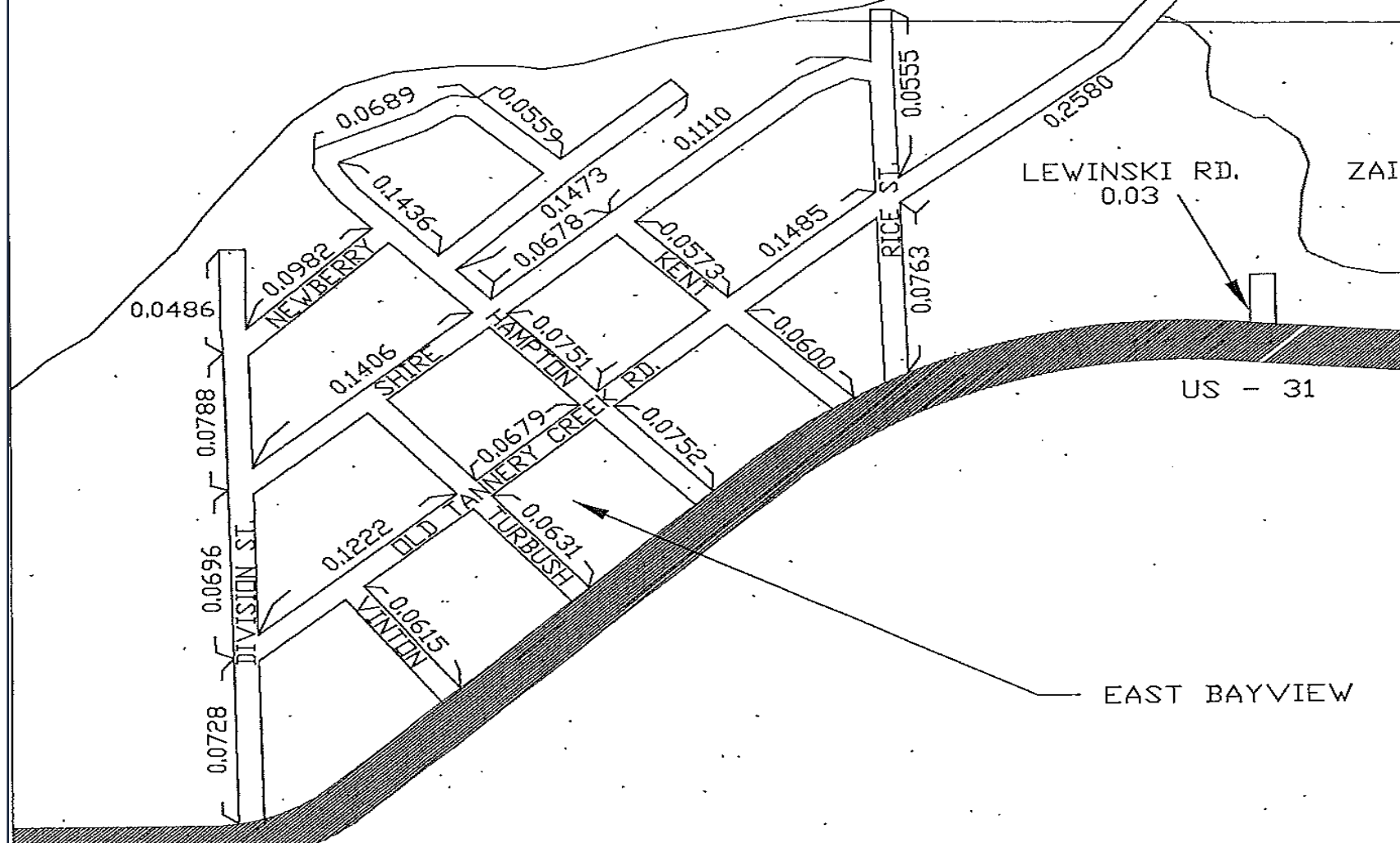

Bids due 9:00 A.M., Tuesday, November 19, 2013
At which time they will be opened and read aloud

BID SHEET

Board of Emmet County Road Commissioners
2265 E. Hathaway Road
Harbor Springs, MI 49740

Gentlemen:

The undersigned purposes to furnish all labor and equipment necessary to provide Snowplow Services as spelled out in the "Invitation to Bid" for the following Routes at the prices listed below:

<u>Route</u>	<u>Name</u>	<u>Cost per Cycle</u>
1.	Pleasantview Route:	\$ _____
2.	Harbor Route:	\$ _____
3.	Bear Creek Route:	\$ _____
4.	Bay View Route:	\$ _____
5.	Resort South Route:	\$ _____
6.	Resort North Route:	\$ _____
7.	Oden Route:	\$ _____
8.	Conway Route:	\$ _____
9.	N. US 31 Route:	\$ _____

Bids due 9:00 A.M., Tuesday, November 19, 2013
At which time they will be opened and read aloud

BID SHEET

Board of Emmet County Road Commissioners
2265 E. Hathaway Road
Harbor Springs, MI 49740

Gentlemen:

The undersigned purposes to furnish all labor and equipment necessary to provide Snowplow Services as spelled out in the "Invitation to Bid" for the following Routes at the prices listed below:

<u>Route</u>	<u>Name</u>	<u>Cost per Cycle</u>
1.	Pleasantview Route:	<u>\$370.00</u>
2.	Harbor Route:	<u>\$260.00</u>
3.	Bear Creek Route:	<u>\$320.00</u>
4.	Bay View Route:	<u>\$250.00</u>
5.	Resort South Route:	<u>\$390.00</u>
6.	Resort North Route:	<u>\$290.00</u>
7.	Oden Route:	<u>\$380.00</u>
8.	Conway Route:	<u>\$370.00</u>
9.	N. US 31 Route:	<u>\$320.00</u>

LEROY P. SUMNER
LARRY WILLIAMS
FRANK ZULSKI, JR.
BRIAN A. GUTOWSKI, P.E.
ENGINEER – MGR.
JUDY FOUCH CLERK



2265 E. HATHAWAY ROAD
HARBOR SPRINGS,
MICHIGAN 49740
OFFICE: (231) 347 – 8142
FAX: (231) 347 – 5787
EMMETCROC@EMMETCROC.COM

Emmet County Road Commission
Tuesday, November 8, 2013

BID TABULATION
SNOW PLOW SERVICES

Harbor Springs Exc.
1084 McBride Park
Harbor Springs, MI 49740
Email: Tom@hsexcavating.net

No Bid

Tri-County Excavating
704 W. Conway Road
Harbor Springs, MI 49740
e-mailed: tricounty@gtlakes.com

\$2950.00

*Truck w/ Sander and Underbody scraper, @ \$125 per hour

Questions?